



■ **Hydraulic tyre changer**  
with wheel diameter pre-selection

■ It can work **on all types**  
**of wheels** from 13" to 32".

■ **4 new versions:**

- START
- VISION
- VISION A
- PLATINUM



**VISION A and PLATINUM**  
with **AUTOMATIC**  
**demounting cycle**

# AQUILA TORNADO



Innovative super-automatic tyre changer  
"WITHOUT LEVER" - CONTACTLESS



## AQUILA TORNADO

**AQUILA TORNADO** is the innovative **CONTACTLESS** tyre changer “without lever” dedicated to the most demanding professionals.

The new **AQUILA TORNADO** is renewed and technologically enriched.

**The automatic wheel width recognition is now available**, as well as the new control console that guarantees improved practicality and ergonomics thanks to the new 19” touch-screen monitor.

The ever-increasing popularity of chrome-plated and repainted alloy rims means that it is essential to avoid any contact with the rim during work operations, not even with plastic-coated components.

The pre-selection of the rim diameter, resulting in automatic positioning of the wheel with respect to the **AUTOMATIC REVOLVER**, and the coordinated movement between the wheel axis and the **REVOLVER**, guarantee easy operation and excellent precision.

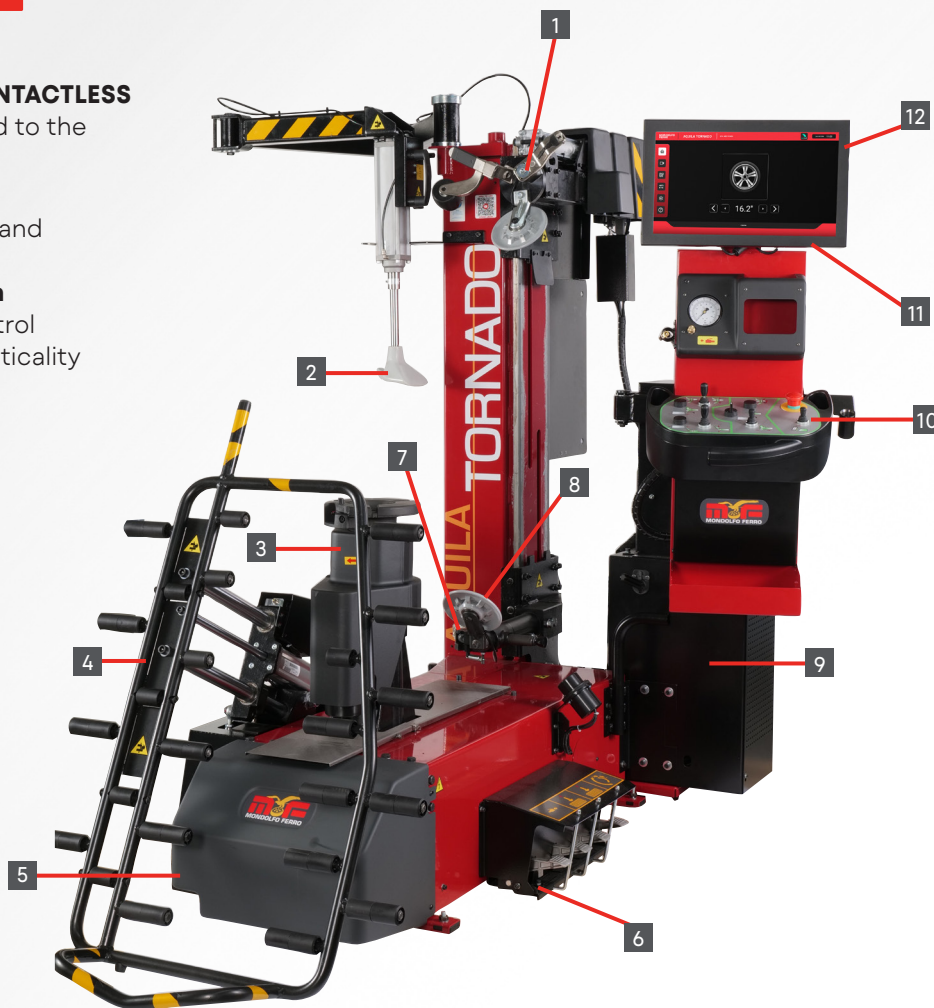

The main features mentioned below represent the strengths of this revolutionary tyre changer capable of operating **on any type of car and light duty vehicle wheel from 13” to 32”**:

- **Hydraulically-controlled operation.**
- **Synchronised** wheel and tool movements.
- **REVOLVER tool** (4 tools) with 3 positions and automatic rotation.

### FEATURES

- 1. REVOLVER tool** (4 tools) with 3 positions and automatic rotation.
- 2. Bead pressing tool.**
- 3. Smart electromechanical centre post turntable** with HYDRAULIC axial movement.
- 4. Wheel lifters:**
  - **Side wheel lifter** with vertical lifting (80 kg).
  - **Premium wheel lifter** with full lifting and lowering movement (85 kg).
- 5. New-generation inverter motor.**
- 6. Ergonomic pedal controls.**
- 7. Manually fold-up tool** for first bead mounting.
- 8. Lower bead breaker disc with automatic wheel width recognition.**
- 9. Hydraulic control unit.**
- 10. New control console.**
- 11. Inflatron electronic inflator** (standard in the SUPER and PREMIUM versions).
- 12. New 19” touch-screen monitor for optimised control**

## STEP 1 SETTING THE WHEEL SIZE



### INTERACTIVE TOUCH-SCREEN

✓ The **interactive touch-screen** allows setting the wheel size in inches and **automatically positioning** the wheel radially with respect to the AUTOMATIC REVOLVER.

**AQUILA TORNADO** is the first machine where the **wheel axis moves simultaneously with the tool** to guarantee precision and efficiency.

- Electronic rim diameter selection with consequent automatic radial positioning of the wheel (micro-adjustment is also possible).
- CAMERA always active that can be displayed on screen (standard in all versions except the START one).
- Selection of 2 tyre demounting programmes: **Normal** and **Soft**.

### PREMIUM WHEEL LIFTER

with automatic movement of the centre post turntable for easier wheel loading



### NEW DISCS WITH SENSORS

The new discs with sensors, the major innovation of this evolution, allow automatic detection of the wheel width when using the automatic bead breaking cycle



PREMIUM wheel lifter control lever.



**STEP 2 WHEEL CLAMPING**



**SMART  
ELECTROMECHANICAL  
CENTRE POST TURNTABLE**

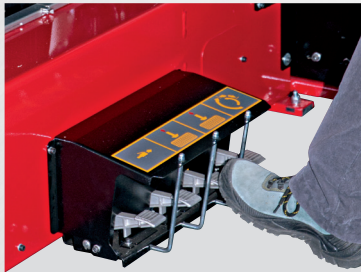

- ✓ **Patented wheel clamping:**  
FAST, SIMPLE, RELIABLE  
for all wheel types  
(complemented by special  
dedicated flanges and cones)

**STEP 3 BEAD BREAKING THE LOWER AND UPPER BEAD**

- ✓ **Hydraulic upper bead breaking operation:**  
the disc descends and the wheel performs  
a specific movement to facilitate the  
bead breaking operation with a controlled  
penetration path.

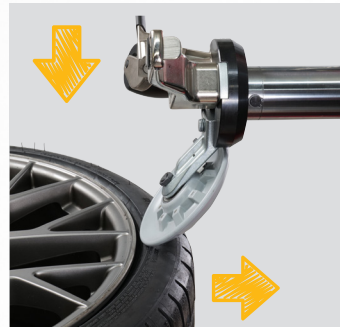

**MULTIFUNCTION REVOLVER WITH NEW DISC  
PROVIDED WITH SENSORS**

- ✓ **Hydraulic lower bead breaking operation:**  
a second independent but specular disc rises and the wheel  
performs a specific movement to facilitate the bead breaking  
operation with a controlled penetration path.



**LOWER TOOL  
WITH MANUAL ENGAGEMENT**

## STEP 4 DEMOUNTING THE UPPER BEAD

- ✓ The DEMOUNTING of the first upper bead is facilitated by the new tool with **mobile spring hook**.  
This important feature allows any type of tyre to be easily and **safely clamped, reducing tension and stress**.

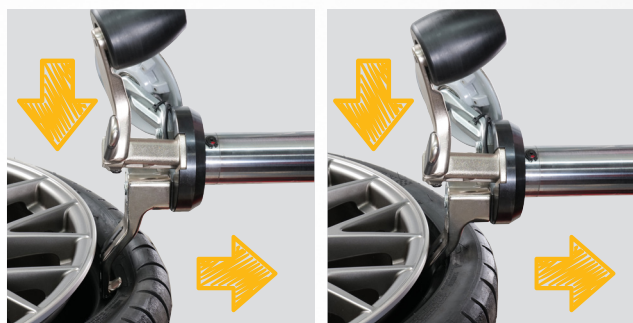

- ✓ During the AUTOMATIC DEMOUNTING CYCLE, the software provides a movement that guarantees the **COMPLETE PROTECTION OF THE TPMS SENSOR**

## STEP 4 AUTOMATIC AUTOMATIC DEMOUNTING

In the versions with **AUTOMATIC DEMOUNTING CYCLE** the operator must only supervise the work without any effort. The wheel width detection, bead breaking and demounting procedures are automated and managed by an efficient program for each wheel. Maximum ease, maximum safety.

## STEP 5 DEMOUNTING THE LOWER BEAD

- ✓ The lower independent bead breaker disc moves upwards until the tyre is brought into the demounting position, an operation that can be facilitated by the **simultaneous movement of the WHEEL UNIT**.



**STEP 6 MOUNTING THE LOWER AND UPPER BEADS**

**A.** The upper BEAD BREAKER DISC and built-in plastic roller push the tyre into the rim.

**B-C.** If required, the lower arm tool will help you perform this operation on particularly soft tyres.

**Complete MOUNTING operation facilitated by tool and built-in presser always in the same position.**

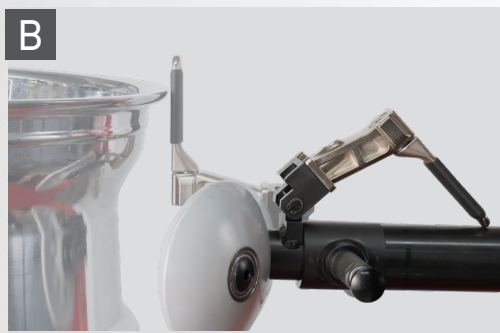

**D-E-F.** By positioning the REVOLVER mounting tool head between the rim and the tyre, the REVOLVER PLASTIC ROLLER will automatically help the tyre to stay in the channel.

The rotation of the centre post turntable and the help of the standard rotating bead pressing tool will make **the final mounting very easy.**



## MOBILE CONTROL CONSOLE

- ✓ All work operations are controlled via the freely positionable console.

**Simple, fast and intuitive controls.**

User-friendly with absolute control in manual operation.



## FITTINGS

	PREMIUM WHEEL LIFTER	BEAD PRESSING TOOL	AUTOMATIC MECHANISM	CAMERA	EL. INFLATOR INFLATRON
<b>START</b>	*	*			
<b>VISION</b>	*	*		*	
<b>VISION A</b>	*	*	*	*	
<b>PLATINUM</b>	*	*	*	*	*

## MACHINE OUTFIT



## TECHNICAL DATA

### Wheel size range

Rim diameter	from 13 to 32"
Max tyre diameter	1200 mm (47")
Maximum tyre width	400 mm (16")
Upper and lower bead breaking force	900 kg

### Electromechanical centre post turntable

Automatic clamping	with handle
Rotation torque	1200 Nm
Rotation speed	7-20 rpm
Motor rating	2-speed inverter motor
Rotation speed	7-18 rpm

### Wheel lifter capacity

85kg

### Power supply

Electric 1Ph	230V-0,75 kW 50Hz/60 Hz
Electric 1Ph (alternative)	115V-0,75 kW 50Hz/60 Hz
Working pneumatics	8 bar
Hydraulic control unit motor	0.8 KW
Operating hydraulic pressure	120 bar
A weighted sound pressure level (LpA) at the workplace	< 70 dB(A)

## DIMENSIONS

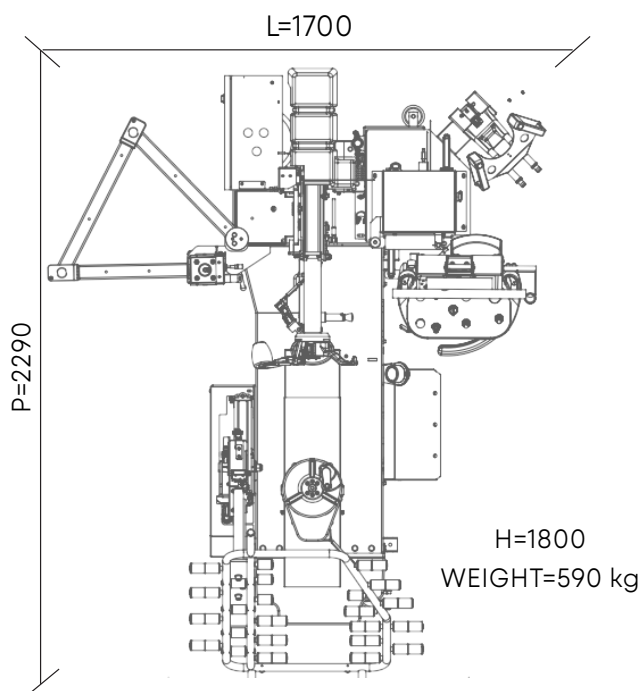

## ACCESSORIES



### A. 8-15100041

ALL IN ONE universal flange  
100mm + spacers 20 mm



### B. 8-11100037

Van and pick-up rim  
rise kit

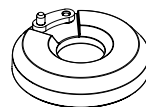

### C. 8-15100003

Special adapter kit for high rims (H=28mm).  
E.g. Porsche rear wheel



### D. 8-15100040

Spacer ring kit H=22mm  
matches with P/N 8-11100037 / 8-11100086 / 8-15100003



### E1. 8-11100404

T.I. inflating system kit

### E2. 8-11100038

T.I. ASME kit (For USA and Canada only)



NEXION SPA  
info@mondolfoferro.it  
www.mondolfoferro.it

Cod. DPMF000798 05/2025

